

SECTION A-A
POLE CAP

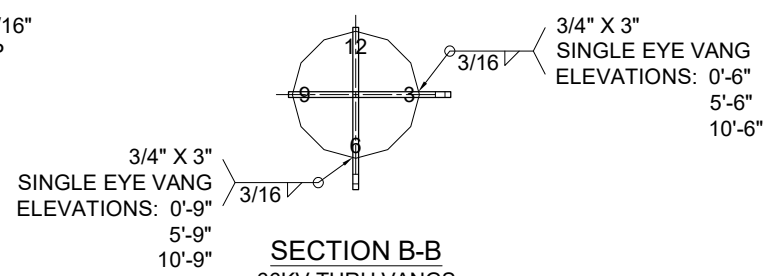

SECTION B-B
66KV THRU VANGS

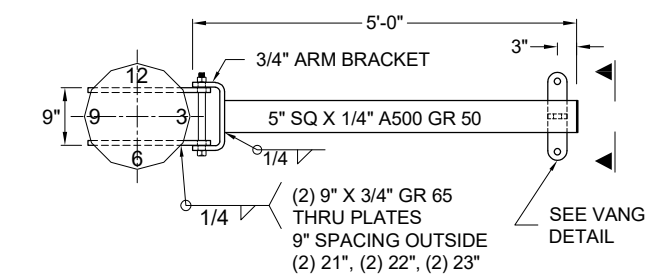

SECTION C-C
66KV DEAD END ARMS

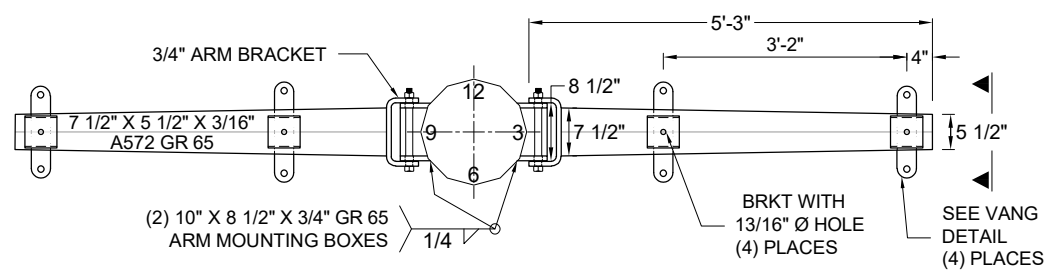

SECTION D-D
16KV DEAD END ARMS

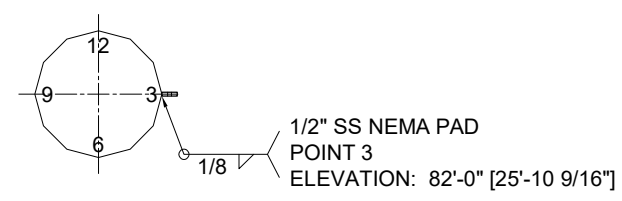

SECTION E-E
GROUND PAD

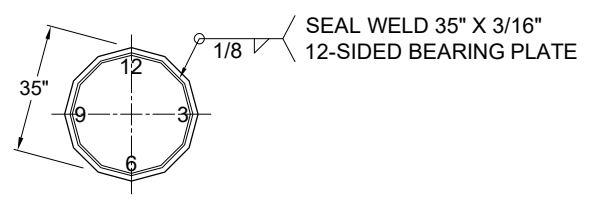

SECTION F-F
BEARING PLATE

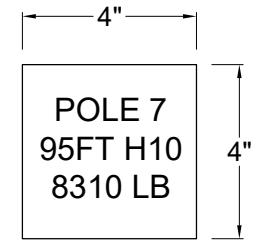

IDENTIFICATION
ENGRAVED ALUMINUM
5FT ABOVE GRADE &
BOTTOM OF TOP & MIDDLE SECTIONS

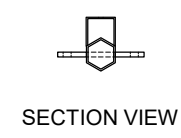

POLE COMPONENT INFORMATION			
ITEM	QTY.	DESCRIPTION	WT. EACH
1	1	STEEL POLE TOP SECTION 39.85' LONG	2,020
2	1	STEEL POLE MIDDLE SECTION 23.95' LONG	1,780
3	1	STEEL POLE BOTTOM SECTION 38.88' LONG	3,680
4	3	5'-0" LONG STEEL ARM 66KV SINGLE PHASE W/ 9"X9" BRACKET	130
5	2	5'-3" LONG STEEL ARM 16KV TWO PHASE W/ 10"X8 1/2" BRACKET	170
6	10	1" X 12" A325 ARM MOUNTING BOLT WITH HH NUT	
TOTAL WEIGHT			8,310 LB

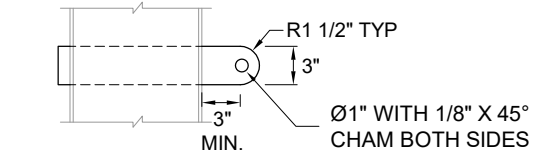
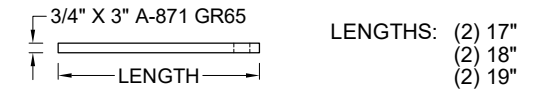

3" SINGLE EYE VANG DETAIL
(6) REQUIRED

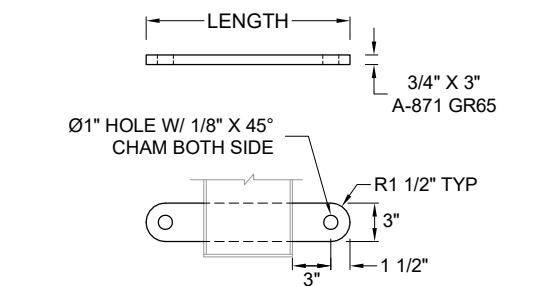

ARM VANG DETAIL
(7) REQUIRED

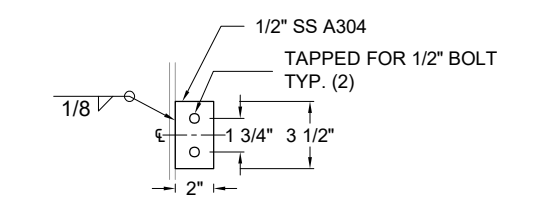

SS NEMA GROUND PAD DETAIL
(1) REQUIRED

POLE DATA TABLE	
POLE FINISH:	GALVANIZED
POLE TYPE:	ALAIN94H10
POLE ALIGNMENT:	ALIGN SECTION ID TAGS
SLIP JOINT JACKING FORCE:	13 TONS PER SIDE
ARM BOLT TIGHTENING:	1/2 TO 2/3 TURN BEYOND SNUG TIGHT
POLE QUANTITY:	(1) REQUIRED

REV	DESCRIPTION	REVISION RECORD	DRAFR	DATE	DESIGNED	DATE	CKED	DATE	APPD	DATE
5										
4										
3										
2										
1										
0	INITIAL DESIGN FOR CUSTOMER REVIEW		BHM	1/23/23	ULD	1/23/23	ULD	1/23/23	ULD	1/23/23

**POLE 7 95FT H10
STEEL POLE DETAILS**

DWG. NO.: POLE 7 95FT H10 SCALE: NONE

UTILITY POLE SOLUTIONS

SHEET NUMBER
1
OF
1